

Architecture  
Interior Design  
Landscape Architecture  
Planning  
Urban Design

Australia  
China  
Hong Kong SAR  
Singapore  
Thailand  
United Kingdom

# 60 MARTIN PLACE PLANNING JUSTIFICATION APPENDIX H VIEW IMPACT ANALYSIS REPORT

Prepared for Investa & Gwynvill Group  
07 July 2014

HASSELL

Issue Date	Description	Reviewed	Approved
04/07/13	FINAL DRAFT	JH	MP
10/07/13	UPDATED FINAL DRAFT	JH	MP
15/08/13	FINAL REPORT	JH	MP
02/02/16	2016 UPDATE	JH	MP

**Contact**

**Matthew Pullinger** Principal  
mpullinger@hassellstudio.com

HASSELL  
Level 2  
88 Cumberland Street  
Sydney NSW  
Australia 2000  
T +61 2 9101 2000  
© April 2013

This report relies upon the information available at the time of writing. Every reasonable effort has been made by HASSELL to ensure that the information in this report is up to date and accurate. HASSELL does not give any guarantees, undertakings or warranties in relation to the accuracy, completeness and currency of the information

01	Introduction	1
02	Proposed Built Form Maximum Envelope	3
03	Key Public Views	5
04	Conclusions	15

## 01 Introduction

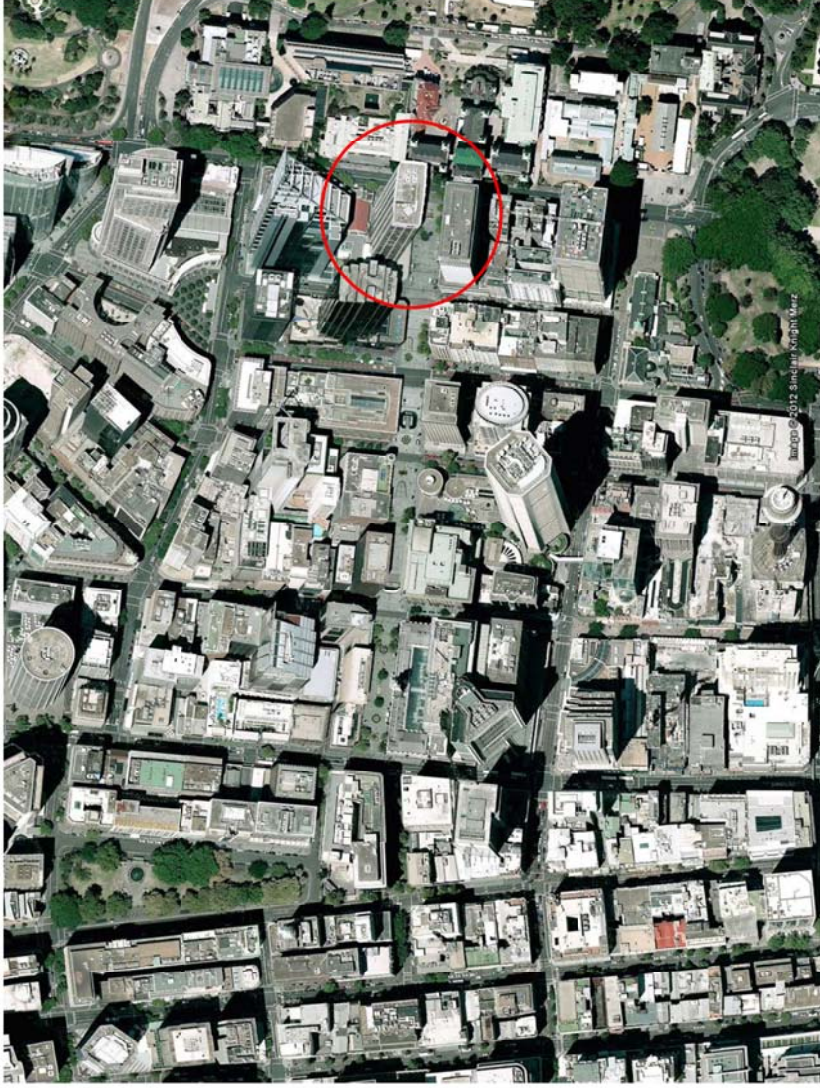

Figure 1: Existing Area, Google Earth

## 01 Introduction

### Introduction

This View Impact Analysis Report is submitted as supporting documentation for a Planning Justification Report prepared by JBA Urban Planning Consultants and should be read in conjunction with this and its appendices. The Planning Proposal seeks an amendment to the Sydney Local Environment Plan 2012 (SLEP 2012) to facilitate the redevelopment of 60 Martin Place. This report has been prepared by Hassell on behalf of Investa Nominees Pty Ltd ATF 60 Martin Place Trust.

This report seeks to examine and assess the visual impact of the proposed development as described by the proposed built form maximum envelope.

### Location

The proposed amendment seeks to facilitate the redevelopment of no.58 - 60 Martin Place and a portion of No 187 Macquarie Street, for the rest of this report referred to as 60 Martin Place.

60 Martin Place is located on the North West intersections of Macquarie Street, Martin Place and Phillip Street. It is bounded on the fourth side by St Stephens Uniting Church and the annex of 126 Phillip Street tenanted by Deutsche Bank. On the southern edge below ground it is bounded by Martin Place Railway Station concourse and tunnels. The site includes 2561 sqm within the boundary of 60 Martin Place plus a 5.5m cantilever over St Stephens Church boundary providing an additional 155 sqm. The existing building consists of a 116/120m tall tower set back from a 16/20m tall podium which was added at a later date.

### Methodology

The view analysis studies contained within this report have been produced by HASSELL using 3D Studio Max, and have been based on a 3D city model of Sydney licenced for use by HASSELL.

The view analysis studies contained within this report are accurate to the implied limits of the supplied base information. HASSELL does not accept responsibility for the accuracy of this base information.

### Guidelines

Section 3.2.1.2 of the Sydney DCP 2012 establishes guidelines for private developments and their relationship to public views:

- (1) *Buildings are not to impede views from the public domain to highly utilised public places, parks, Sydney Harbour, Alexandra Canal, heritage buildings and monuments including public statues, sculptures and art.*
- (2) *Development is to improve public views to parks, Sydney Harbour, Alexandra Canal, heritage buildings and monuments by using buildings to frame views. Low level views of the sky along streets and from locations in parks are to be considered.*



## 02 Proposed Built Form Envelope

2

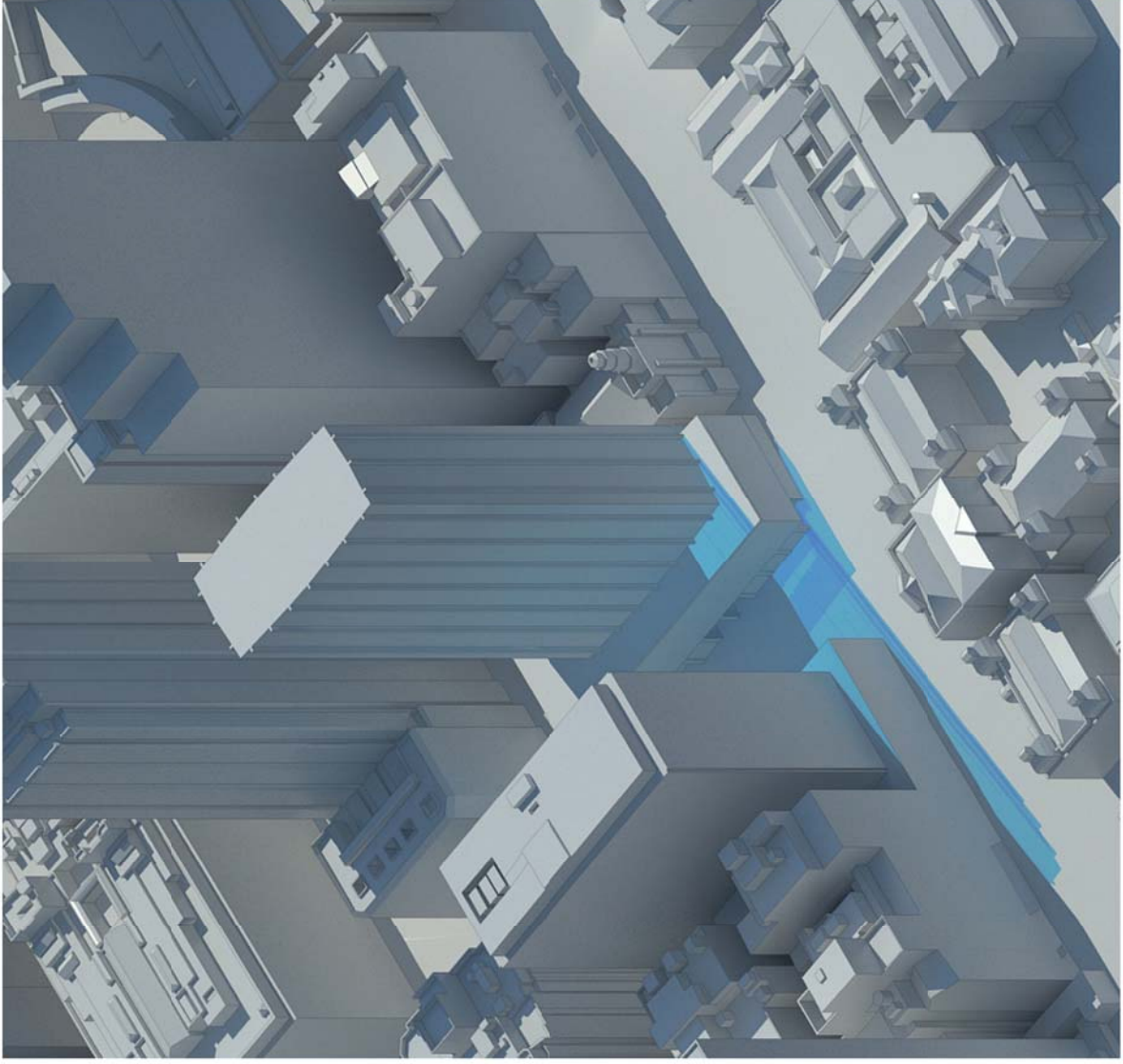

Figure 1. Existing Building

## 02 Proposed Built Form Maximum Envelope

The diagram on the opposite page describes the existing building and context.

The diagram to the right describes the proposed built form maximum envelope. This envelope has been defined by:

- solar access controls set out by The City of Sydney,
- and agreed setbacks to Martin Place and Macquarie Street that respond to the particular context, or surrounding buildings, notably St Stephens Church, the RBA and the Sydney Hospital.

This envelope describes the maximum envelope within which any future development must sit. It does not describe a building form as such. There are many possible massing options that may sit within this envelope with more detailed articulation and with a lesser visual impact.

For more information on how this envelope has been determined please refer to Appendix A - Urban Design Analysis Report.

This report illustrates and analyses the visual impact of the proposed built form maximum envelope from key views around the city. For the purposes of this report this envelope includes the proposed built form maximum envelope (in light orange) but not the roof feature zone (dashed).

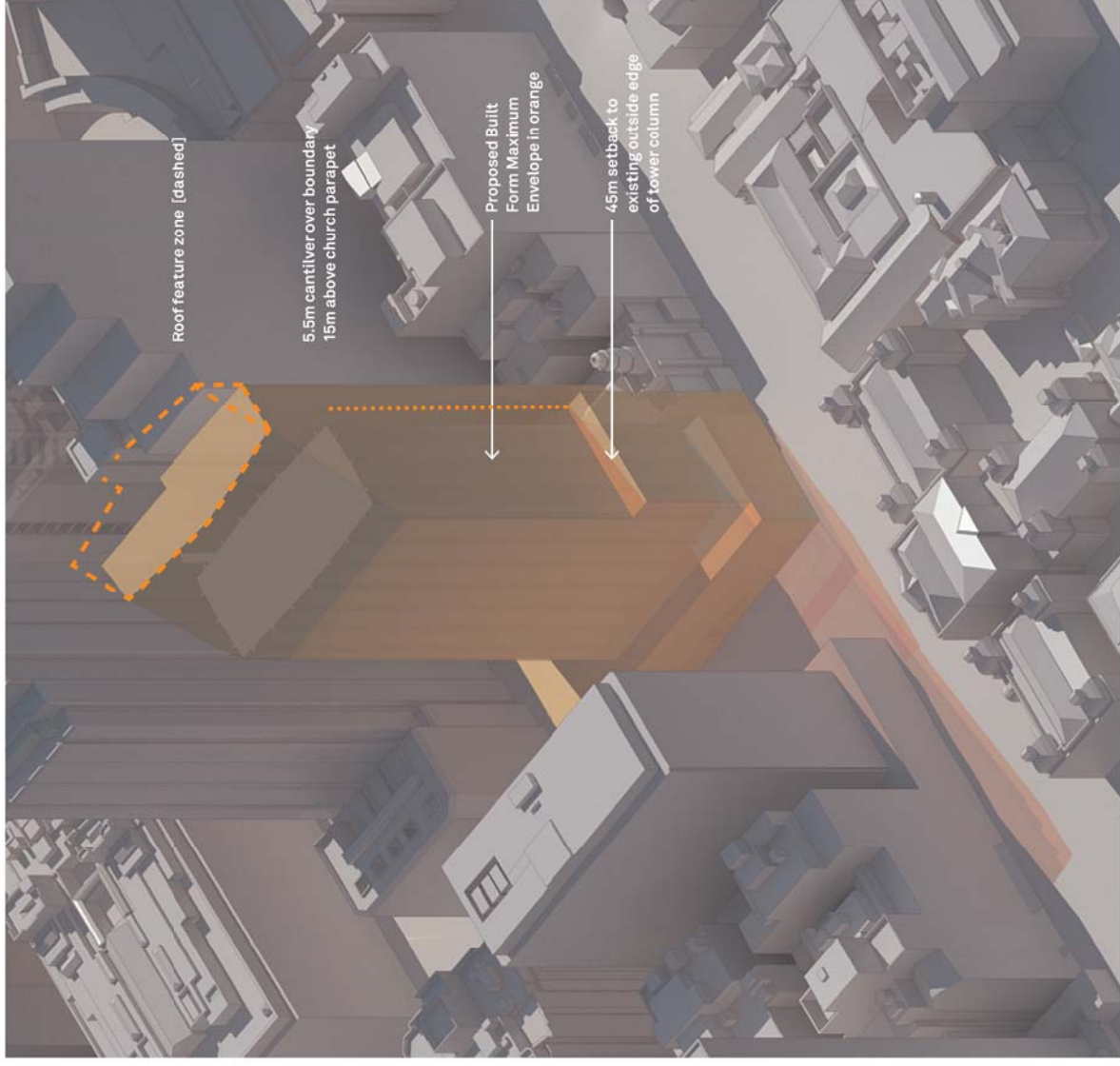

Figure 1. Proposed built form maximum envelope

### 03 Key Public Views

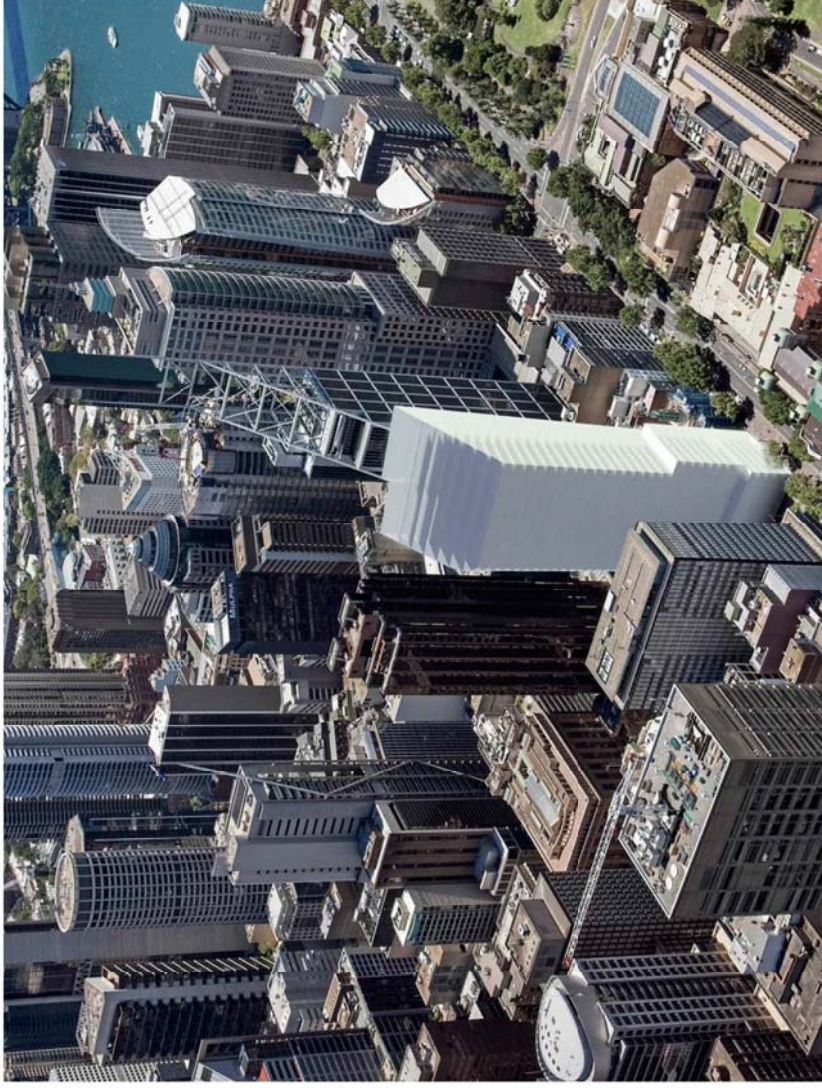

Figure 1 - Existing aerial with illustrative missing option - Copyright Airviewonline



### 03 Key Public Views

The image opposite describes the proposed built form maximum envelope in context. It does not describe an architectural massing. A detailed design scheme will be developed at a later stage.

The views below have been selected in consultation with The City of Sydney and the 60 Martin Place design team.

They seek to analyse the impact of the proposed development on Martin Place, Macquarie Street and Phillip Street and from key public spaces around the city.

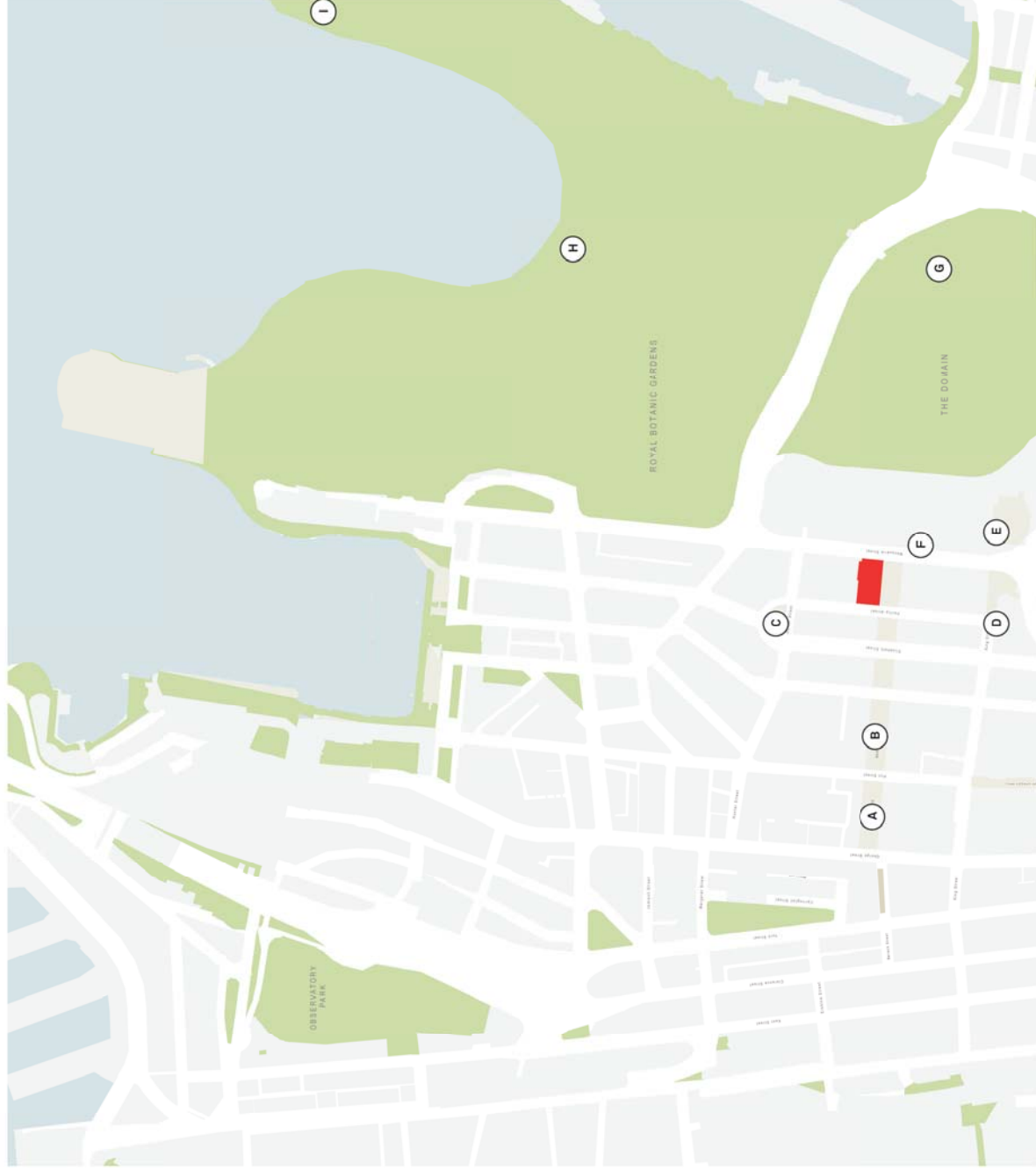

Figure 1. Map illustrating location of key views

#### Key Public Views

- A** Martin Place (GPO)
- B** Martin Place (between Pitt and Castlereagh)
- C** Chifley Square (at Phillip/ Hunter)
- D** St James Church (at Phillip/ King)
- E** Hyde Park Barracks
- F** View of St Stephens Spire  
(from outside The Sydney Eye Hospital)
- G** State Art Gallery/ Domain
- H** Botanical Gardens
- I** Sydney Harbour

### 03 Key Public Views

View A

Martin Place (GP0)

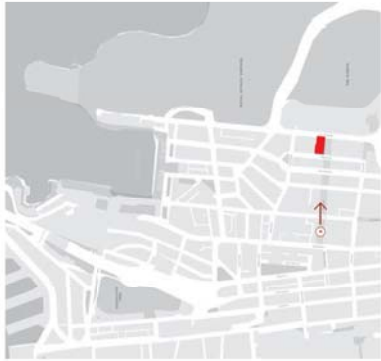

Figure 1. Key



Figure 2. Existing



Figure 3. Proposed

#### Legend

- Existing building
- Proposed built form envelope



### 03 Key Public Views

#### View B

Martin Place (between Pitt Street and Castlereagh Street)

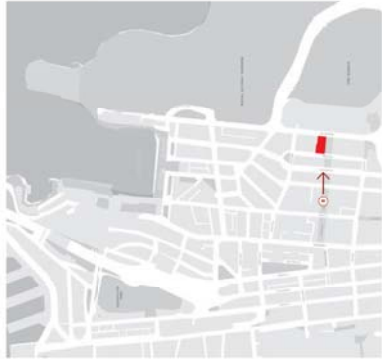

Figure 1. Key



Figure 2. Existing



Figure 3. Proposed

#### Legend

- Existing building
- Proposed built form envelope

### 03 Key Public Views

#### View C

#### Chifley Square (at Phillip Street / Hunter Street intersection)



Figure 1. Key



Figure 2. Existing



Figure 3. Proposed

#### Legend

- Existing building
- Proposed built form envelope



### 03 Key Public Views

#### View D

St James Church (at Phillip Street / King Street intersection)

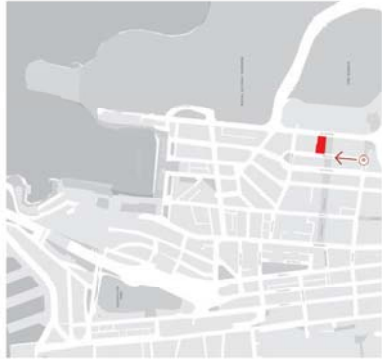

Figure 1. Key



Figure 2. Existing



Figure 3. Proposed

#### Legend

- Existing building
- Proposed built form envelope

### 03 Key Public Views

#### View E

#### Hyde Park Barracks

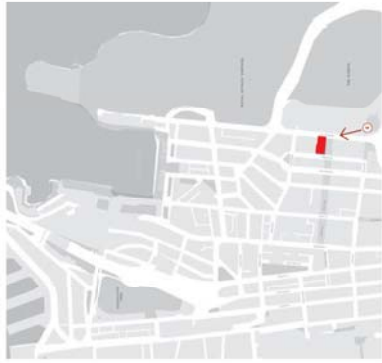

Figure 1. Key



Figure 2. Existing



Figure 3. Proposed

#### Legend

- Existing building
- Proposed built form envelope



### 03 Key Public Views

#### View F

Macquarie Street (looking north towards St Stephens Church spire)

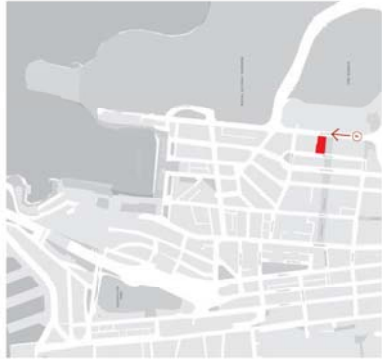

Figure 1. Key



Figure 2. Existing



Figure 3. Proposed

#### Legend

- Existing building
- Proposed built form envelope

### 03 Key Public Views

12

View G

Art Gallery of NSW

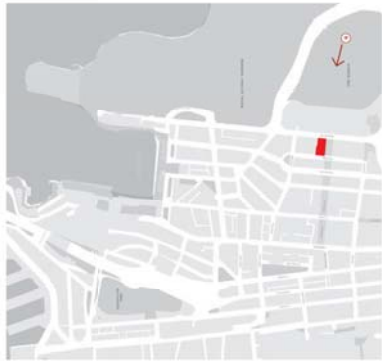

Figure 1. Key



Figure 2. Existing



Figure 3. Proposed

#### Legend

- Existing building
- Proposed built form envelope



### 03 Key Public Views

#### View H

#### Royal Botanic Gardens

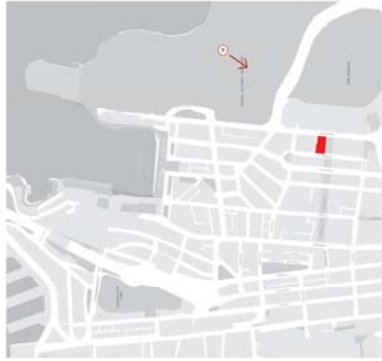

Figure 1. Key



Figure 2. Existing

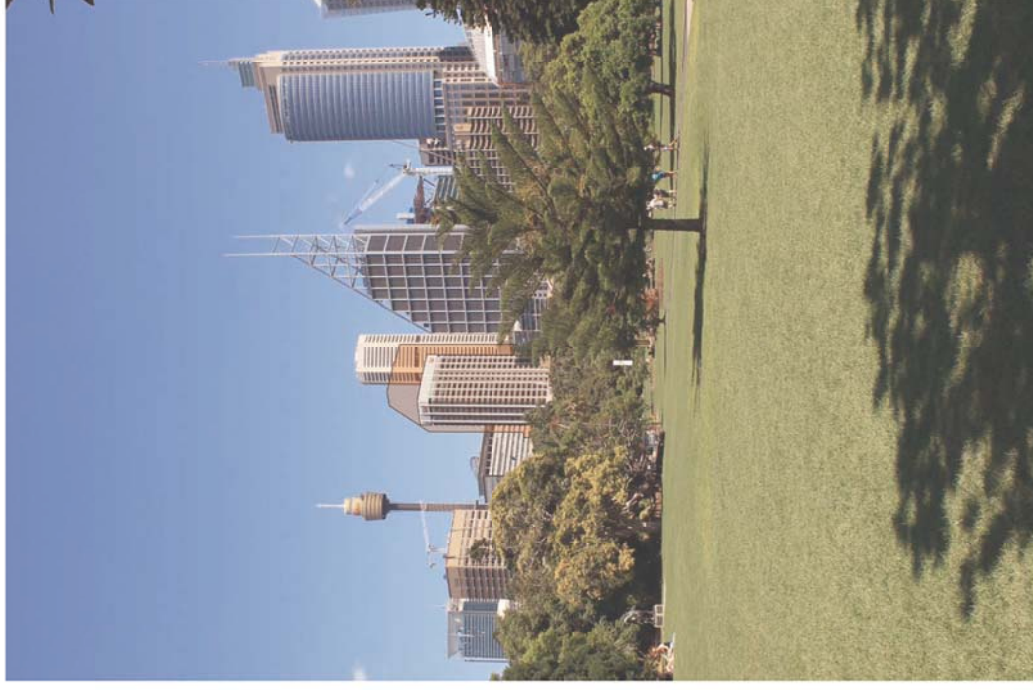

Figure 3. Proposed

#### Legend

- Existing building
- Proposed built form envelope

### 03 Key Public Views

#### View 1

#### Sydney Harbour

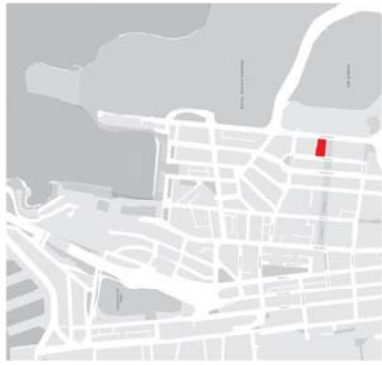

Figure 1. Key



Figure 2. Existing



Figure 3. Proposed

#### Legend

- Existing building
- Proposed built form envelope

## 04 Conclusions

### Conclusion

This proposal is consistent with the guidelines set out in the DCP in that it does not impede views from the public domain and conserves and enhances the existing relationship to the surrounding heritage context.

As seen from Martin Place the proposal will extend into a minor portion of the skyline beyond the current building. When considered within the surrounding context the proposed setback equal to the RBA is not detrimental to the public space but frames this space adding to the symmetry and formal character of Martin Place. It can be argued that this will provide a more cohesive linear enclosure to the space which will if anything strengthen the vista terminating this eastern end.

This report demonstrates that the proposed building maximum envelope has a negligible visual impact on the character of the existing streets and on views from the key public spaces around the city.

A final design solution has the opportunity to improve the views with the addition of a premium commercial building, demonstrating design excellence and enhancing the characters and public domain of both Martin Place and Macquarie Street.

The allowance for an architectural roof feature zone, set back to avoid overshadowing, will enable the redevelopment to make a positive contribution to the city skyline and provide a stronger identity for the building.

## South East Asia

### Bangkok

HASSELL  
18F, K Tower  
209 Sukhumvit Soi 21  
Klongtoey-Nua Wattana  
Bangkok 10110 Thailand  
T +66 2207 8999  
E bangkok@hassellstudio.com

### Singapore

HASSELL  
17A Stanley Street  
068736 Singapore  
T +65 6224 4688  
E singapore@hassellstudio.com

## United Kingdom

### Cardiff

HASSELL  
4th Floor, James William House  
9 Museum Place  
Cardiff CF10 3BD United Kingdom  
T +44 29 2072 9071  
E cardiff@hassellstudio.com

### London

HASSELL  
Level 2, Morelands  
17 – 21 Old Street  
Clerkenwell  
London EC1V 9HL United Kingdom  
T +44 20 7490 7669  
E london@hassellstudio.com

## China

### Beijing

HASSELL  
Building A7  
50 Anjiatou  
Chaoyang District  
Beijing 100125 China  
T +86 10 5126 6908  
E beijing@hassellstudio.com

### Chongqing

HASSELL  
28F, International Trade Centre  
38 Qing Nian Road  
Yu Zhong District  
Chongqing 400010 China  
T +8623 6310 6888  
E chongqing@hassellstudio.com

### Hong Kong SAR

HASSELL  
22F, 169 Electric Road  
North Point, Hong Kong SAR  
T +852 2552 9098  
E hongkong@hassellstudio.com

### Shanghai

HASSELL  
Building 8 Xing Fu Ma Tou  
1029 South Zhongshan Road  
Huangpu District  
Shanghai 200011 China  
T +8621 6887 8777  
E shanghai@hassellstudio.com

### Shenzhen

HASSELL  
37F, Landmark  
4028 Jintian Road  
Futian District  
Shenzhen 518035 China  
T +86755 2381 1838  
E shenzhen@hassellstudio.com

## Australia

### Adelaide

HASSELL  
Level 5  
70 Hindmarsh Square  
Adelaide SA  
Australia 5000  
T +61 8 8220 5000  
E adelaide@hassellstudio.com

### Brisbane

HASSELL  
36 Worry Street  
Fortitude Valley QLD  
Australia 4006  
T +61 7 3914 4000  
E brisbane@hassellstudio.com

### Melbourne

HASSELL  
61 Little Collins Street  
Melbourne VIC  
Australia 3000  
T +61 3 8102 3000  
E melbourne@hassellstudio.com

### Perth

HASSELL  
Podium Level, Central Park  
152 – 158 St Georges Terrace  
Perth WA  
Australia 6000  
T +61 8 6477 6000  
E perth@hassellstudio.com

### Sydney

HASSELL  
Level 2  
Pier 8/9, 23 Hickson Road  
Millers Point NSW  
Australia 2000  
T +61 2 9101 2000  
E sydney@hassellstudio.com